

# corner bead with a sharp edge

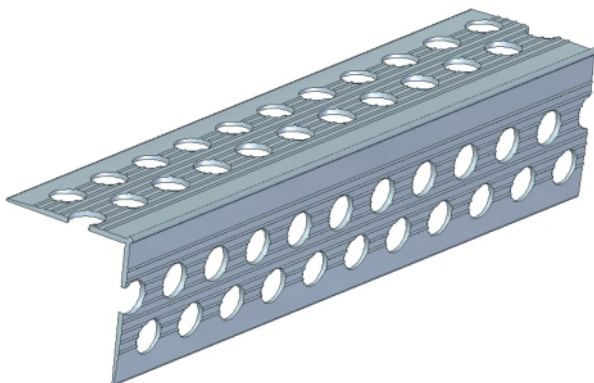

- used for protection, stabilization and accurate edges making
- reinforcement of corners and edges
- protects the corners, edges and jambs of windows and doors against mechanical damage
- the profile is set to the edge and fixed accordingly in respect to the plaster thickness; the set layer is aligned
- aesthetic appeal – forms perfectly straight corners in thin-walled plasters
- corner profiles cover over corner areas in optimum way
- sharp edge simplify plaster smoothing
- chemically stable, not reacting with a plaster

Material	Dimension mm	Ordering No.	Length m	Packing pcs
PVC	25 x 25	C/17	2,5	100
PVC	25 x 25	C/17.3	3	100

## Recommendation:

A recommended clip on distance is 10 cm. Apply the profile on extremely exposed places (corners). To shorten the profile use scissors designed for work with plastic profiles.

## Storage:

A horizontal storage position is recommended. The profiles packed cardboard covers need to be stored in a dry place. Maximum recommended storage time is 24 months.